

# Jefferson Electric

## ENCAPSULATED TRANSFORMERS

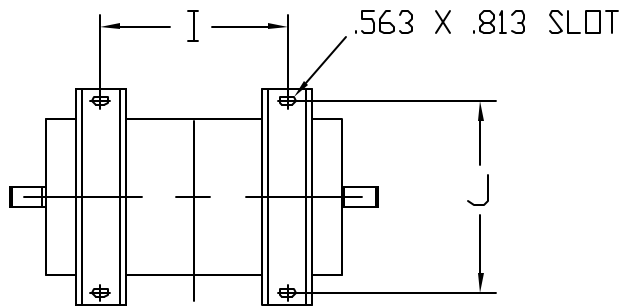
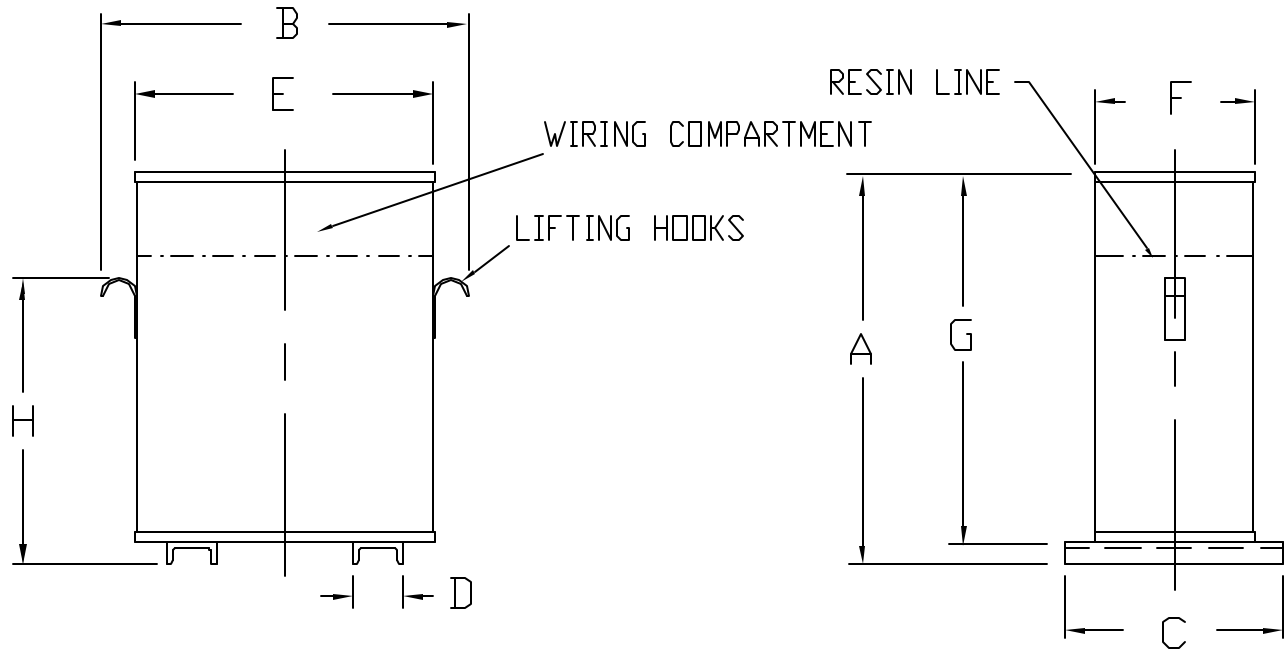

(K):-

- ① ALUMINUM WOUND
- ② COPPER WOUND

KVA	TEMP. RISE C°	NET WT. LBS.	HOUSING DIMENSIONS										
			A	B	C	D	E	F	G	H	I	J	K
30	135	500	36.00	21.25	12.75	2.00	18.25	8.75	35.00	27.38	13.00	11.25	①
45	135	580	36.00	21.25	12.75	2.00	18.25	8.75	35.00	27.38	13.00	11.25	①
75	135	860	36.00	24.00	14.38	2.00	21.12	11.00	35.00	27.38	13.00	12.88	②

### NOTES:

1. ALL UNITS ARE UL LISTED AND DESIGNED IN ACCORDANCE WITH ANSI, NEMA, AND CSA STANDARDS.
2. THESE TRANSFORMERS UTILIZE A UL RECOGNIZED 180°C INSULATION SYSTEM, TEMPERATURE RISE AS INDICATED IN THE TABLE.
3. TRANSFORMERS ARE ENCAPSULATED WITH ELECTRICAL GRADE RESIN IN A NEMA 3R-RATED ENCLOSURE, BUILT IN ACCORDANCE WITH NEMA, ANSI, UL, AND CSA STANDARDS.
4. PAINT COLOR IS ANSI #61 GRAY.



GENERAL PURPOSE TRANSFORMERS  
THREE-PHASE, 600 VOLTS CLASS, 60 HZ.  
ENCAPSULATED

PCD 213-FIGURE-6

REV.  
A